







## Quick Guide – GH1 F

- The ceiling hoist is switched on by pressing one of the buttons on the hand control.
  - If the hoist does not switch on, this may be because the emergency stop button has been activated.
  - Attach the travelling trolley anchor with cord to the locking mechanism at the top of the hoist. Using the switch at the top of the hand control unit, select the  hoist installation function. Start installation by pressing the "up" button . Move the switch at the top of the hand control to the position  to complete the installation. The hoist can now be used for relocating.
  - For deinstallation of the hoist, choose the function  and press on the "down" button . Wait until the cord is fully extended
- before pressing the locking mechanism to release the hoist anchor.
  - The hoist can be recharged by inserting the power supply plug into the charge point of the hand control unit and switching on the power supply. The plug should always be inserted into the hand control when the hoist is not in use.
  - The hoist's maximum lifting capacity will be marked on the hoist, e.g., 255 kg/560 lbs. Note that the rail system or the sling may have a lower lifting capacity. The lowest lifting capacity may not be exceeded.
  - If you have any questions regarding instructions and training, ask your environmental health & safety coordinator, human resources manager or your line manager.

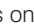

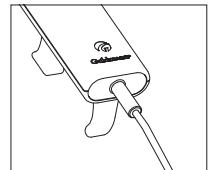
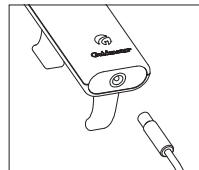
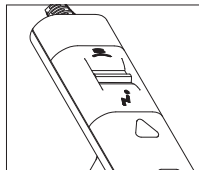
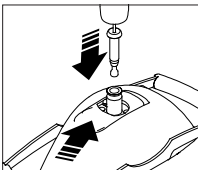
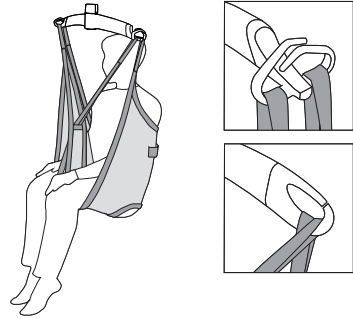
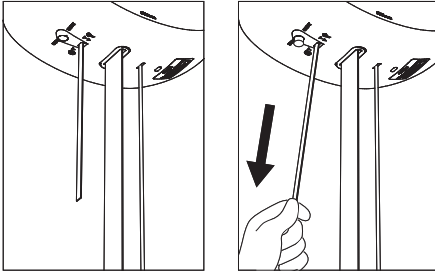

## Safety functions

### Emergency stop

- One pull on the red strap. Use only in emergencies, when there is an immediate need to stop the hoist.
- When the emergency stop is activated, only the hoist's emergency lowering device will function.
- Deactivate the emergency stop by pressing the "stop" button (yellow button) on the hoist. Then press one of the buttons on the hand control unit twice.

### Emergency lowering device

This is activated by a prolonged pull on the red strap. Use only in an emergency. This function allows the patient to be lowered when the hoist has failed to work.



**Scan here for user manual, etc. concerning use of the GH1 F.**

## Accessories

### Lifting hanger

Place the sling straps in the hooks. Check that the straps have been correctly attached to the hanger.

### Lifting sling

We recommend using a lifting sling with two or four loop attachments for attaching the sling to the lifting hanger. The sling must always correspond with the hoist's lifting capacity. In case of doubt concerning the use of a lifting sling, please contact your supplier.

## Daily cleaning and maintenance

Clean with a damp cloth and ordinary detergent. Do not use strong acids, bases or alcohol when cleaning. See user manual.

| Time to care |

**For Sales or Customer Service please contact:**

Goldmann Inc. - (800) 664-8834